

HIGH SPEED HDMI® CABLE

1.8 METRE 1080P HIGH QUALITY TRANSFER

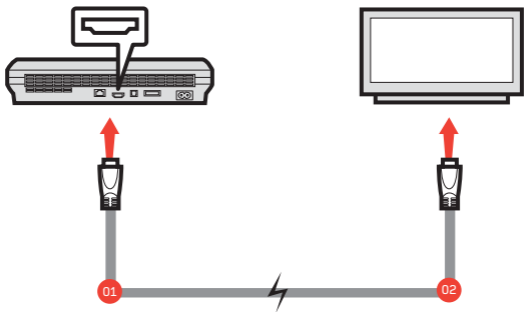
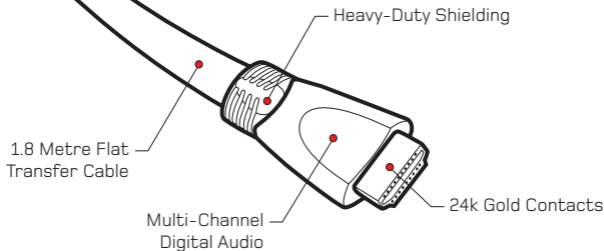

care & maintenance

This product has been designed with the highest concern for safety. However, any electrical device, if used improperly, has the potential to cause harm. To help ensure risk-free operation please pay attention to the guidelines below.

precautions

- Use only as intended.
- This is a precision product and should be handled with care.
- To avoid electrical shock, do not take the product apart.
- Do not store in areas of extreme heat or cold.
- Do not allow product to get wet or dirty; doing so may damage the product.
- Do not clean with benzene, paint thinner, acetone, alcohol, or other such solvents.

environment

Recycling is important and will help to protect our environment and reduce landfill waste.



Please help to conserve the environment by recycling the inner cardboard packaging of this product.



This cable should NOT be disposed of in normal household waste. It should be disposed of separately. Please take it to an electrical waste collection point.

troubleshooting

Having trouble with your High-Speed HDMI® Cable? For further assistance please contact our customer support team from our website at www.gioteck.com

Copyright © 2009, 2010 GBB Group. All Rights Reserved.

Gioteck and the Gioteck Logo are trademarks of GBB Group Ltd.

HDMI, the HDMI logo and High-Definition Multimedia Interface are trademarks or registered trademarks of HDMI licensing, LLC. Playstation®, Playstation®3 & PS3™ are registered trademarks of Sony Computer Entertainment Inc. This product is not endorsed or manufactured by Sony Computer Entertainment Inc. or any of its divisions.